

Centrifugal Pump KIPW60 Series KIPW60A-12L

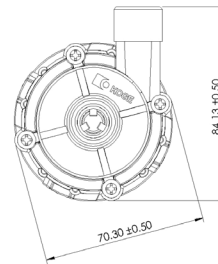

Unit:mm

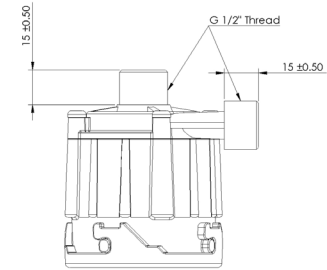
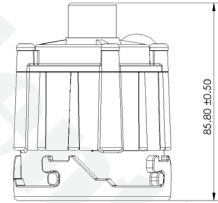

Concept

A centrifugal pump made up of two main components, including rotating system and a stationary part. It is a mechanical device designed to move a fluid by means of the transfer of rotational energy from one or more driven rotors, called impellers. Fluid enters the rapidly rotating impeller along its axis and is cast out by centrifugal force along its circumference through the impeller's vane tips. The action of the impeller increases the fluid's velocity and pressure and also directs it towards the pump outlet.

Features

- ▶ Continuous working mode
- ▶ Stable and lower vibration
- ▶ Low power consumption
- ▶ Oil-free operation
- ▶ No/low maintenance
- ▶ High efficiency with long lifetime 20,000hours

Application

- ▶ Industrial devices
- ▶ Electric shower
- ▶ Circulation systems
- ▶ Cleaning equipment
- ▶ Water treatment
- ▶ Dish washer/ Aquariums

Model Key

Category	KOGE	Pump	Type	Pump Head Diameter	Series A~Z	Voltage	Series	Output
Centrifugal	K	IP	W	60	A	12	L	KIPW60A-12L

Specifications

Rated Voltage	12.0 V
Max Current	3.0 A
Max. Noise form 100cm	< 50 dB(A)
Ideal Life Time	20,000 hrs
Max. Flow	18.0 L/min
Max. Pressure	80 kPa
Working Voltage Range	8~14V
Media	Pure Water
Power Consumption	36W
Protection Functions	voltage protection, overcurrent protection, temperature protection
Liquid Temperature	0-100°C
Power Supply	DC power supply

Materials

Motor	Brushless motor
Axle	Ceramics
Bearing	Graphite
Housing	PPE
Pump Head	PPE

Curve Graph

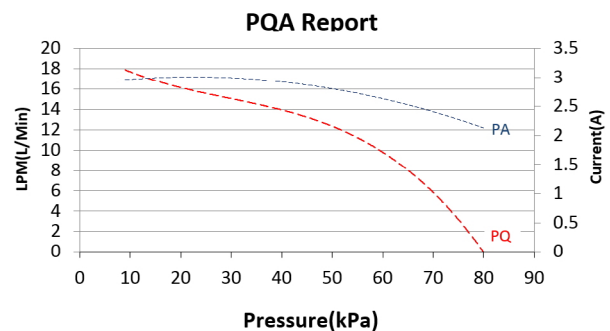

Usage Note:

- ▶ The pump is not self-priming
- ▶ The pump shall not be operated running dry
- ▶ Reversed polarity condition harms the electronics (Custom-made is an exception)
- ▶ All repairs to the pump must be carried out by KOGE customer service team
- ▶ The actual performances would vary accordingly from test conditions, media temperature, and the environment of users